

# Michael and Susan Dell Hall

## Technical Specifications



For Questions concerning Technical Specifications, please contact:

Technical Director - Jim Larkin (512) 457.5130 or [jlarkin@thelongcenter.org](mailto:jlarkin@thelongcenter.org)

### Seating and House Capacity:

Orchestra:	530 Seats
Orchestra Pit:	112 Seats
Parterre:	499 Seats
Mezzanine:	620 Seats
Balcony:	681 Seats
<b>Total:</b>	<b>2442 Seats</b>

All levels are wheelchair and handicap accessible.

Assistive listening devices are available upon request.

### Stage Dimensions

Proscenium Opening:	54'-0" wide x 31'-0" high (Width and height of proscenium is flexible down to 38'-0" using the hard portal legs and hard portal border on linesets 1 and 2 as a false proscenium)
Stage Depth:	52'-6" deep
Hard Portal Border:	60'-0" wide x 20'-0" high
Hard Portal Legs:	14'-0" wide x 35'-6" high
House Curtain:	60'-0" wide x 20'-0" high
Orchestra Pit Depth:	17'-0" deep
Stage Floor to Trap Room Floor:	10'-4"
Stage Height from Orchestra Floor:	3'-11"
Stage Floor to Gridiron:	84'-4"
Stage Floor to Roof Support Beams:	93'-6"
Stage Floor to Fly Gallery Lock Rail:	28'-0"
Stage Floor to Mid-Level Gallery:	48'-0"
Stage Floor to Mid-Loading Rail:	70'-0"
Stage Floor to Upper-Loading Rail:	78'-0"

---

## Counterweight Fly System

The Dell Hall Stage has a double purchase counterweight fly system with a locking rail and two loading rails located stage left. The locking rail is equipped with white and blue index lights as well as rope lights used for cue lights. There is a pin rail equipped with belaying pins for spot-line rigging at the mid gallery position. A fire curtain and dedicated house curtain are both motorized and are located immediately upstage of the proscenium.

A blank hang schedule is located on pages 16 and 17.

Total number of manual line-sets with truss battens:	74 (61 Useable)
Batten Length:	72'-0"
Batten Travel:	78'-0"
Batten Height at Deck Level (Bottom Chord):	3'-8"
Batten Height at Deck Level (Top Chord):	4'-10"
Standard Arbor Height:	14'-0"
Concert Ceiling Arbor Height:	20'-0"

---

## Concert Shell

**Ceilings:** There are five Wenger Diva Series acoustical ceilings with white finish. They are hung on dedicated manual counterweight linesets with taller arbors. Each ceiling includes nine ETC Source Four PAR light fixtures. Each panel is eight inches deep.

**Towers:** There are twelve Wenger Diva Series free-standing acoustical towers with a cherry finish. Each tower is self-supported and movable. They are available as back and side walls. When deployed the towers are approximately 12'-0" wide and 30'-0" high.

---

## Softgoods

The following softgoods are available in-house.

Description	Quantity	Height	Width
House Curtain	1	36'-0"	60'-0"
Black Velour Borders	6	12'-0"	70'-0"
Black Velour Legs	12	40'-0"	16'-0"

Black Velour Tabs	10	40'-0"	10'-0"
Black Velour Bi-Part Traveler (Two 40'-0" x 36'-0" Panels)	1	40'-0"	70'-0"
Blackout Panel	1	40'-0"	70'-0"
Cyclorama	1	38'-0"	70'-0"
Black Scrim	1	38'-0"	70'-0"
White Scrim	1	38'-0"	70'-0"
Rear Projection Screen	1	40'-0"	70'-0"
Small Projection Screen*	1	15'-0"	26'-6"
Large Projection Screen*	1	24'-0"	42'-0"

\*This information duplicated in Theatrical Video Systems section.

---

## House Main Curtain

The House Main Curtain is made of 24 ounce velour and is rigged on a dedicated winch assisted arbor drive line set. It is guillotine only with a center split- the curtain is not rigged to open horizontally.

---

## Variable Acoustics

The Hall is equipped with a variable acoustic system designed by Jaffe Holden Acoustics. The system uses a series of motorized Venetian style banners and tracked curtains to alter the acoustics of the room. This enables the room to become more 'live' or 'dead' depending on the needs of the event. The curtains are 25 ounce velour with 100% fullness.

---

## Stage Floor

The stage floor, in order of construction, includes a resilient neoprene rubber vapor barrier, sleepers, 2 layers of ¾" plywood, and is topped with ¼" masonite. It has a flexible trap area located in the center of the stage. The trapped portion of the stage begins 6'-8" upstage of the plaster line, is 59'-0" wide, extends 22'-9" upstage, and is on the centerline.

A full-stage black Harlequin Cascade Marley Vinyl dance floor with a sub floor is available. Contact The Long Center for more information.

---

## Orchestra Pit Lifts

The Orchestra pit consists of two platforms raised and lowered on Spiralift columns. They can be set on-level with the Orchestra seating section to allow more seating, used as a full or half orchestra pit at basement level, or set on-level with the stage to be used as an apron.

Unit Static Load:	150 pounds per square foot
Static Load Capacity:	87,600 pounds
Unit Lifting Load:	50 pounds per square foot
Lift Load Capacity:	29,200 pounds
Lift Speed:	10 feet per minute

---

### **Loading Dock**

The loading dock area has two loading dock doors: (1) 20' wide x 10' high and (1) 8' wide x 8' high. They are located on the south end of the Long Center and will accommodate three semi-tractor trailers simultaneously. Two of the spaces are equipped with molded dock bumpers and powered recessed dock levelers that compensate for the differences in height between truck bed and loading dock. A dock plate is available for the third space.

The delivery and service yard is shared with the Palmer Events Center. The Long Center must coordinate all deliveries and trucking in advance.

---

### **Green Room**

The green room/performers lounge is equipped with audio and video monitors. It accommodates up to 40 people.

### **Dressing Rooms**

There are nine dressing rooms for the cast and performers with an additional four star dressing rooms. All are equipped with audio monitors with independent volume controls. Video monitors for a stage view are available at these locations. Contact The Long Center for more information if needed.

<b>Dressing Rooms</b>	<b>Location</b>	<b>Capacity (per room)</b>
4 - Large	Basement Level	10
1 - Large	Basement Level	20
3 - Medium	Orchestra Level	6
2 - Star	Stage Level	1 each

1 - Medium	Stage Mezzanine Level	6
2 - Star	Stage Mezzanine Level	1 each

### **Laundry Room**

Laundry facilities are available at the basement level. There are three household size washing machines and three household size dryers. The room has six 20-amp circuits for washers and six 30-amp split phase circuits for dryers. This room also has a household style sink that is dedicated for laundry use. The dyeing of costumes is not permitted in any of the washing machines.

### **Wardrobe Room**

The Dell wardrobe room is located on the basement level near the Laundry Room. It is 400 sq. ft. with seven 20A 120v circuits. Work tables and chairs are provided. Eighteen (18) rolling wardrobe racks are stored here.

### **Wig Room**

The wig room is adjacent to the Laundry room on the basement level. It is 375 sq. ft. and has four 20A 120v circuits. This room has a small basin style sink dedicated for wig maintenance. Shelves, work tables, and chairs are provided.

---

## Concert and Theatrical Lighting

The Hall is equipped with a first class lighting system including high rise dimmers dedicated to the house lights and concert lighting circuits. This technology insures the quietest operation from the house and concert lighting by preventing filament noise during concert performances. *Concert lighting fixtures are permanently hung and focused and are not available for general stage lighting use without prior arrangement and additional expense.*

There is no set “house plot”. All lighting equipment is scheduled on an as-needed basis. Expendables such as gel and templates can be provided with sufficient notice at additional expense.

The following equipment is currently in inventory; The Long Center makes no guarantees as to future availability.

### Lighting Control

- 1 ETC Eos Control System with 4000 outputs and full tracking backup processor  
Manufacturer’s website about this product:  
<http://www.etcconnect.com/minisite/eos/>
- 1 Wireless Eos Remote Focus Unit
- 636 2400 Watt ETC Sensor Dimmers
- 18 6000 Watt ETC Sensor Dimmers
- 54 2400 Watt ETC Sensor High Rise Dimmers
- 42 2400 Watt ETC Non Dimmable Circuits
- 12 Portable 2-Port DMX Nodes

### Lighting Fixture Inventory (does not include concert fixtures)

- 12 ETC 5-degree Source Four ERS with 750-watt lamp
- 30 ETC 10-degree Source Four ERS with 750-watt lamp
- 28 ETC 14-degree Source Four ERS with 750-watt lamp
- 36 ETC 19-degree Source Four ERS with 750-watt lamp
- 66 ETC 26-degree Source Four ERS with 750-watt lamp
- 52 ETC 36-degree Source Four ERS with 750-watt lamp
- 24 ETC 50-degree Source Four ERS with 750-watt lamp
- 12 ETC 15-30 degree Source Four Zoom ERS with 750-watt lamp
- 12 ETC 25-50 degree Source Four Zoom ERS with 750-watt lamp
- 48 ETC Source Four PAR with 750-watt lamp

- 18 Strand Fresnelite 8" with 2000-watt lamp
- 15 L&E Runt 4-cell Cyc fixture with 650-watt lamps
- 12 L&E Zip Strip 40-cell Cyc lights with 75-watt MR-16 lamps (EYC)
- 10 50lb round boom base for 1 ½" threaded pipe
- 10 21' long 1 ½" threaded pipe with safety tie off

Additional accessories (top hats, gobo holders, irises and sidearms) are available with advance notice.

## **Additional Lighting Equipment Available from The Long Center**

- 1 Flying Pig Systems Road Hog Full Boar Console (2048 DMX outputs)  
Manufacturer's website about this product:  
<http://www.highend.com/products/controllers/FullBoarConsole.asp>
- 16 High End System Studio Command 1200 (moving yoke wash fixture)
- 6 SeaChanger Color Mixing Units in 26 degree Source Four
- 6 SeaChanger Color Mixing Units in 36 degree Source Four
- 4 Lycian Model 1293 Follow Spots with 3000-watt Xenon lamp
- 24 Wybron 4" Coloram IT Gel Scrollers
- 1 Diffusion DF-50 Hazer (does not include fluid)
- 2 High End Systems F-100 Fogger (does not include fluid)

## **Lighting Network and DMX distribution**

Ethernet ports for access to the ETCNET lighting network are distributed throughout the theater. All data distribution is via the lighting network– there are no DMX dry lines in the facility. To protect the integrity of the lighting system, only approved equipment may be connected to the lighting network.

## Front of House Lighting Positions

The following lighting positions are available downstage of the plaster line. All circuits terminate in stage pin connectors. Non-dim circuits are relay switched, suitable for powering motors and moving lights at 120v.

<b>Position</b>	<b># of lighting circuits (not including concert circuits)</b>	<b>Distance from Plaster Line</b>	<b>Height from Stage Floor</b>	<b>Throw to 0'-0"</b>
Followspot Booth	4 @ 20A, 2 @ 20A non-dim	93'	66'	114'
Far Catwalk	6 @ 20A (SL of C), 6 @ 20A (SR of C), 2 @ 20A non-dim	93'	66'	114'
Mid Catwalk	36 @ 20A, 2 @ 50A, 2 @ 20A non-dim	70'	67'	97'
Near Catwalk	24 @ 20A, 2 @ 20A non-dim	47'	67'-3"	82'
Apron Catwalk	12 @ 20A, 2 @ 20A non-dim	14'-3"	46'	48'
Projection Booth	2 @ 20A, 2 @ 50A, 2 @ 20A non-dim	122'	33'	126'
Balcony Rail	12 @ 20A, 2 @ 50A, 2 @ 20A non-dim	88'	36'	95'
Mezzanine Rail	6 @ 20A, 2 @ 50A, 2 @ 20A non-dim	83'	17'-3"	85'
High Opera Box HR	12 @ 20A, 1 @ 20A non-dim	54'-0" to 27'-8"	42'-9"	63'-3" to 82'-0"
Mid Opera Box HR	8 @ 20A, 1 @ 20A non-dim	54'-0" to 27'-8"	26'-9"	54'-0" to 73'-9"
Low Opera Box HR	4 @ 20A, 1 @ 20A non-dim	54'-0" to 27'-8"	18'	49'-0" to 70'-0"
High Opera Box HL	12 @ 20A, 1 @ 20A non-dim	54'-0" to 27'-8"	42'-9"	63'-3" to 82'-0"
Mid Opera Box HL	8 @ 20A, 1 @ 20A non-dim	54'-0" to 27'-8"	26'-9"	54'-0" to 73'-9"
Low Opera Box HL	4 @ 20A, 1 @ 20A non-dim	54'-0" to 27'-8"	18'	49'-0" to 70'-0"
High Box Boom SL	9 @ 20A, 1 @ 20A non-dim	16'-6" to 11'-3"	36' to 28'-8"	53'-6"
Mid Box Boom SL	9 @ 20A, 1 @ 20A non-dim	16'-6" to 11'-3"	22' to 14'-9"	45'-3"

Low Box Boom SL	None (cable run from stage as needed)	16'-6" to 11'-3"	7'-9" to 0'	40'-3"
High Box Boom SR	9 @ 20A, 1 @ 20A non-dim	16'-6" to 11'-3"	36' to 28'-8"	53'-6"
Mid Box Boom SR	9 @ 20A, 1 @ 20A non-dim	16'-6" to 11'-3"	22' to 14'-9"	45'-3"
Low Box Boom SR	None (cable run from stage as needed)	16'-6" to 11'-3"	7'-9" to 0'	40'-3"

## Onstage Lighting Positions

There are no dedicated electrics or lighting battens. A total of 312 overhead 20A circuits can be distributed via six-circuit Socapex cables to any batten. Staggered-length and same-length breakouts are available. Four 50A circuits are also available at grid level.

All circuits terminate in stage pin connectors. Non-dim circuits are relay switched, suitable for powering motors and moving lights at 120v. Additional circuits are available at or near stage level in the following locations:

Location	# of lighting circuits
Pin Rail Stage Left	36 @ 20A, 1 @ 20A non-dim
Pin Rail Stage Right	36 @ 20A, 1 @ 20A non-dim
Downstage Left Proscenium Wall	8 @ 20A, 1 @ 20A non-dim
Downstage Right Proscenium Wall	8 @ 20A, 1 @ 20A non-dim
Upstage Left Wall	12 @ 20A, 2 @ 50A, 1 @ 20A non-dim
Upstage Right Wall	12 @ 20A, 2 @ 50A, 1 @ 20A non-dim
Upstage Center Wall	12 @ 20A, 2 @ 50A, 1 @ 20A non-dim
Orchestra Pit	6 @ 20A, 1 @ 20A non-dim
Trap Room	8 @ 20A, 2 @ 20A non-dim

## Cue Light System

- 1 Leon Audio 14-channel master control unit mounted in SM Panel (on stage)
- 1 Leon Audio 14-channel portable master control unit
- 14 Leon Audio QLS-B Mk3 cue light station

Connection jacks for cue light stations are available throughout Dell Hall. The fly rail is permanently equipped with three colors of rope light that are used for fly cue lights. There is a maximum of 14 cue lights with this system.

## Theatrical Audio Systems

Every decision that went into the design and construction of The Long Center was driven by acoustics. Painstaking measures and a no-compromise attitude were adhered to ensure pristine acoustics and immaculate audio quality. The HVAC system of the room is noiseless as the vents are low volume and hidden under the seats. The HVAC air handlers are also spring mounted to the floor away from Dell Hall. The Concert Lighting system uses High Rise Dimmers to prevent filament noise from the light fixtures. The following equipment is currently in inventory; The Long Center makes no guarantees as to future availability.

### Loud Speakers

The permanent loud speakers in Dell Hall are manufactured by Eastern Acoustic Works. The main components are hidden in the proscenium in a left-center-right configuration. The other components are distributed throughout the hall. The system utilizes QSC amplifiers.

Location	Quantity	Speaker Model	Amplifier Model
Center Cluster Array-Top Tier	4	EAW KF737P Custom	QSC CX902/1102
Center Cluster Array-Bottom Tier	3	EAW KF730P	QSC CX902/1102
Side Towers - Top Tier	2	EAW MQM1343e Custom	QSC CX302/702
Side Towers - Middle Tier	2	EAW MQM1364e	QSC CX302/702
Side Towers - Middle Tier	2	EAW LF1410 Custom	QSC CX902
Side Towers - Bottom Tier	2	EAW MQM1394e	QSC CX302/702
Side Towers - Sub Woofers	4	EAW LF1815 Custom	QSC CX1102 & Lab.Gruppen 68:4
Orchestra Box Fills	6	EAW UB12Se	QSC CX254
Front Fill	8	EAW UB52-JHA Custom	QSC CX404
Under Mezzanine	8	EAW UB52	QSC CX404
Under Balcony	6	EAW UB52	QSC CX404
Over Balcony	4	EAW MK2394e	QSC CX502
Control Room	2	EAW UB12Se	QSC CX404
Control Room	1	Bag End S10e-1	QSC CX404
Studio Monitors	4	Mackie HR624	Self-Powered
Effects/Monitor	4	EAW JFX88	QSC CX702
Effects/Monitor	4	EAW SM200iH	QSC CX702
Effects/Monitor	4	EAW SM260iV	QSC CX702
Spot Monitor	2	Mackie SRM-150	Self-Powered

### Sound Equipment

#### Available Amplifiers

Amount	Manufacturer	Model	Description
4	QSC	CX702	2-Channel Power Amplifier. These amps can be used for EAW portable speakers: JFX88, SM200iH, and SM260iV. 425W @ 8Ω. 700W @ 4Ω.

### House Mixing Console

Amount	Manufacturer	Model	Description
1	Yamaha	PM5D-RH	48-mono inputs, 4-stereo inputs, 4-stereo effect inputs, 24-mix outputs, 8-matrix outputs

Manufacturer's website about this product:

<http://www.yamaha.com/ca/productdetail/0..CNTID%25253D48177%252526CTID%25253D560488.00.html>

### Outboard Processing Equipment

Amount	Manufacturer	Model	Description
1	Ashley	Protea 4.24G	Graphic equalizer – 4 channel
1	TC Electronics	M3000	Effects processor
1	Eventide	Eclipse	Effects processor

### Playback and Recording

Amount	Manufacturer	Model	Description
1	HNB	CDR830 Plus “Burn It”	CD Recorder
1	Denon	DN-T625	CD Player and Cassette Deck
1	Tascam	MD-CD1	Minidisc and CD Player
1	Tascam	MD-350	Minidisc Recorder

### Assisted Listening System

A Sennheiser Infrared assisted listening system is available from Guest Services. Call for more information.

### Theatrical Intercom System

Dell Hall has a built in four-channel Clear-Com system. There are connections in all production areas and backstage areas.

Amount	Manufacturer	Model	Description
2	Clear-Com	V-BOX	Portable Wall Station Box
8	Clear-Com	RS-601	Remote Belt pack
2	Clear-Com	RS-602	Remote Belt pack, 2 Channel
2	Beyerdynamic	DT-109.28 400B	Headset- Double Muff
2	Beyerdynamic	DT-108.28 400B	Headset- Single Muff
2	Clear-Com	CC-260	Headset- Double Muff

6	Clear-Com	CC-95	Headset- Single Muff
2	Clear-Com	HS-6	Handset
1	Clear-Com	TW-40	Walkie-Talkie Interface

### **Paging System**

A networked paging system serves to page the lobby, backstage, and stage areas. Paging may be performed from the portable SM Rack and from the Guest Services office.

### **Console Positions**

Positions for the mixing console include the sound booth at the back of the orchestra, a “front porch” position in front of the light booth in the upper orchestra, and a center mix position near the center of the orchestra. The front porch and center mix positions each require seat pulls.

### **House Mic Lines & Tie Lines**

A 56 input snake runs from the stage to either the sound booth, front porch position, or center mix position. There are 24 tie lines between the booth and the stage, 8 tie lines to the Rollins Studio Theatre, and 8 tie lines to the loading dock.

## Microphones and Direct Input Boxes

Amount	Manufacturer	Model	Description
6	Shure	SM57-LC	Dynamic Instrument Microphone
6	Shure	SM58-LC	Dynamic Handheld Vocal Microphone
2	Shure	SM81-LC	Instrument Condenser Microphone
2	Shure	Beta 87C	Vocal Condenser Microphone
4	Sennheiser	MD421 II	Dynamic Microphone
6	AKG	C 535 EB	Handheld Condenser Microphone
8	BSS	AR-133	Active DI
2	AKG	C 451 B	Condenser Instrument Microphone
2	Audio-Technica	ES935ML (ES935S/C)	Condenser Gooseneck Microphone
2	Shure	Beta 52A	Kick Drum Microphone
4	Crown	PCC-160	Boundary Microphone
6	Shure	Beta 98D/S	Condenser Percussion Microphone
4	Audio-Technica	AT3035	Condenser Microphone
2	Audio-Technica	U857 QL 16"	Gooseneck Microphone

## Ancillary Equipment

Amount	Manufacturer	Model	Description
1	Whirlwind	PRESS POWER 2	Press Box With Case
3	Whirlwind	MS-12-0-NR-050-SS	Microphone Sub Snake

## Additional Audio Items

Amount	Manufacturer	Model	Description
4	Clear-Com	WBS-670/4	Wireless Clearcom with Four Packs
2*	DPA	SMK4061	Stereo Condenser Microphone Kit
2	Shure	UR4D Wireless Receiver	Dual Channel J5 Frequency Receiver
4	Shure	UR1 Bodypack	Transmitter with MKE2 Lavalier Mic
4	Shure	UR2 Beta87 Handheld	Handheld Mic with built-in Transmitter
1	Millennia	HV-3C	Dual Channel Microphone Pre-Amp
1	DBX	162SL	Dual Channel Compressor/Limiter

\*Matched Pair

## Theatrical Video Systems

The following equipment is currently in inventory; The Long Center makes no guarantees as to future availability.

### Projector\*

Amount	Manufacturer	Model	Description
1	Christie Digital	CP2000S	2k Resolution (2048x1080), 22000 ANSI Lumen, DLP Cinema Projector.

### Accessories

Amount	Manufacturer	Model	Description
1	Christie	CineIPM 2k	Video Scaler which allows composite, S-Video, Component SD, Component HD, DVI, VGA, RGBHV, 2x DVI, SDI, and HD-SDI input.
1	AnalogWay	Octo-Fade 2	Video scaler which allows composite, S-Video, Component, VGA, and DVI input with cross fading (for analog inputs only).
1	Pioneer	DVD-V8000	DVD Player w/ DVI Upscaling**

### Projection Screens

Amount	Manufacturer	Model	Description
1	DA-LITE***	Fast Fold	Front Projection Video Screen. 26'-6" x 15'-0" Viewable Area Aspect: 1.6777
1	Stewart Film Screen***	Ultramatte 130 Screen. CinePerf perforations.	Front Projection Video Screen. 42'-0" x 24'-0" Viewable Area Aspect: 1.75 Movie theatre style screen.

\*The distance from projector location to plaster line is 127'-7". The Christie Projector is permanently installed and cannot be moved.

\*\*This DVD player cannot upscale a copyrighted DVD.

\*\*\*This information duplicated in Soft Goods section.

## **Video Hardwire Information**

Dell Hall is wired with BNC video connectors. BNC panels for composite video are located in all technical areas. These connections route to a patch bay and AutoPatch system located in the projection booth. Video for cameras and monitors can be routed from this location. There are also Cat-5 panels for video as well as a patch bay in the projection booth for video-over-Cat-5 solutions.

## Stage Area Power

All connections and disconnections to these panels must be performed by house personnel. Nominal voltage is 120/208v 3 phase, 60Hz. All Cam-Lok connections have neutral and ground reversed.

### Company Switches

Amperage	Location	Connection Type	Notes
400 Amps	DSR on Proscenium	Cam-Lok / Tie-In	Double Neutral
400 Amps	DSR on Proscenium	Cam-Lok / Tie-In	Double Neutral
100 Amps	DSR on Proscenium	Cam-Lok, Distro to Stage Pin and Edison on Wall	8 @ 20A stage pin, 8 @ 20A edison
60 Amps	DSR on Proscenium	60 Amp Pin and Sleeve*	Isolated Ground, Audio Only
60 Amps	DSL on Proscenium	60 Amp Pin and Sleeve*	Isolated Ground, Audio Only
100 Amps	DSL on Proscenium	Cam-Lok, Distro to Stage Pin and Edison on Wall	8 @ 20A stage pin, 8 @ 20A edison
200 Amps	DSL Wing Wall	Cam-Lok	Isolated Ground, Audio Only
100 Amps	MSL Wing Wall	Cam-Lok, Distro to Stage Pin and Edison on Wall	8 @ 20A stage pin, 8 @ 20A edison
100 Amps	USL Upstage Area Wall	Cam-Lok, Distro to Stage Pin and Edison on Wall	8 @ 20A stage pin, 8 @ 20A edison
100 Amps	USR Upstage Area Wall	Cam-Lok, Distro to Stage Pin and Edison on Wall	8 @ 20A stage pin, 8 @ 20A edison
100 Amps	USR Upstage Wall	Cam-Lok, Distro to Stage Pin and Edison on Wall	8 @ 20A stage pin, 8 @ 20A edison
400 Amps	DSR on Mid Rail	Cam-Lok / Tie-In	Double Neutral
400 Amps	DSR on Mid Rail	Cam-Lok / Tie-In	Double Neutral
100 Amps	USR on Mid Rail	Cam-Lok	
100 Amps	USR on Gridiron	Cam-Lok	
100 Amps	USL on Gridiron	Cam-Lok	
100 Amps	DSR on Forestage Gridiron	Cam-Lok	
400 Amps	Loading Dock Receiving Area	Cam-Lok / Tie-In	Double Neutral
100 Amps	Trap Room Under Stage	Cam-Lok	

\*Dell Hall is also equipped with Pin and Sleeve cables and breakout boxes:

Amount	Manufacturer	Part #	Description
--------	--------------	--------	-------------

2	Leviton	Connectors are 560P9W	50' 60-Amp Pin and Sleeve Cable
2	Union Connector	56DBT-06122U-IG	60-Amp Pin and Sleeve Breakout Box with 12 circuit breakers with 2 Edison connectors each.

### On Stage Audio Power

Onstage and in the house of Dell Hall there are numerous power outlets with orange Edison connectors. These have an isolated ground specifically for audio equipment. They should only be used for such.

## Visiting Production Office

This visiting production office is located on the entry level, under the Dell stage, next to the trap room.

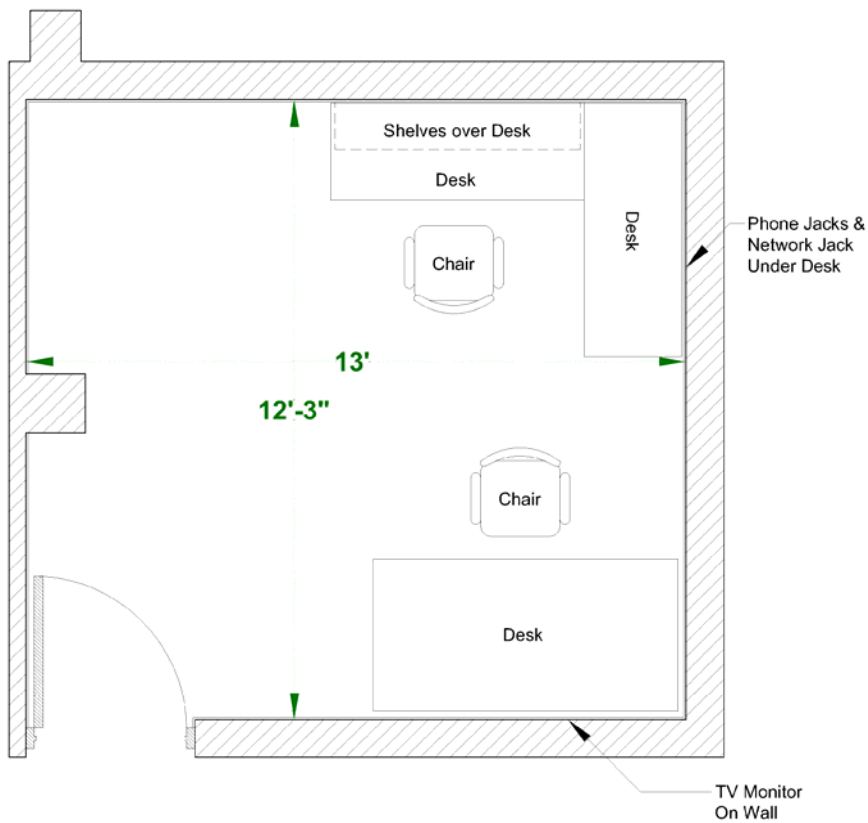

### Office Information

- Phones  
512-457-5100 ext. 138  
512-457-5100 ext. 139  
The phones are IP-Phones and are provided.
- One jack for wired Internet access available
- Three desks, shelves on the wall, and two chairs.
- TV Monitor with stage view
- Copy machine & fax machine located across the hall in the crew



break room.

# On Stage Crew Office

This office is located just off the stage right wing in Dell Hall.

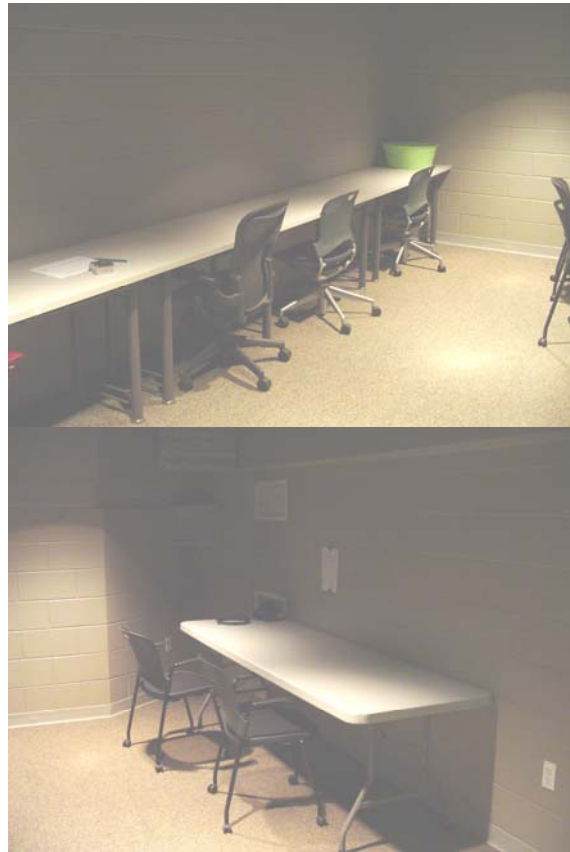
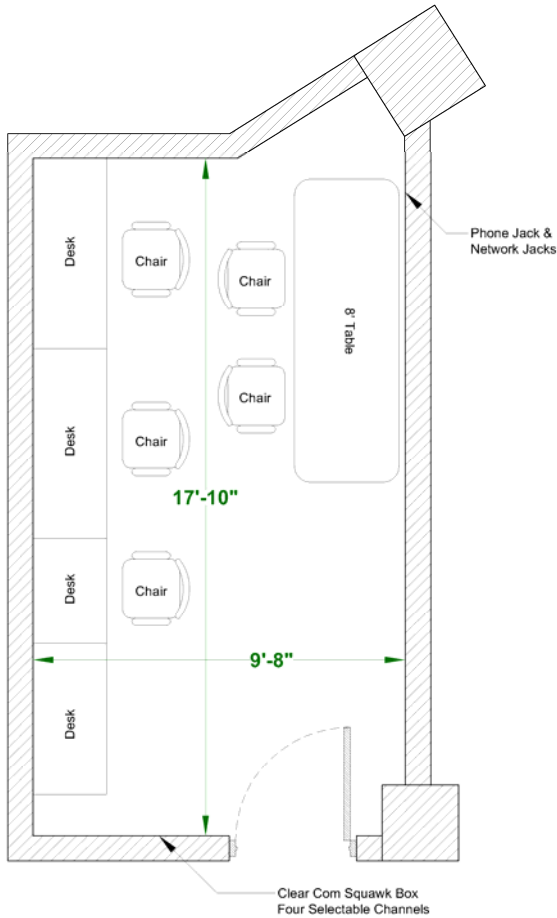

## Office Information

- Phones  
512-457-5100 ext. 210  
The phone is an IP-Phone and provided.
- Fax Machine  
512-457-5140
- Two jacks for wired Internet access available
- Three desks, shelves on the wall, and two chairs.
- Four desks, one 8' table, and

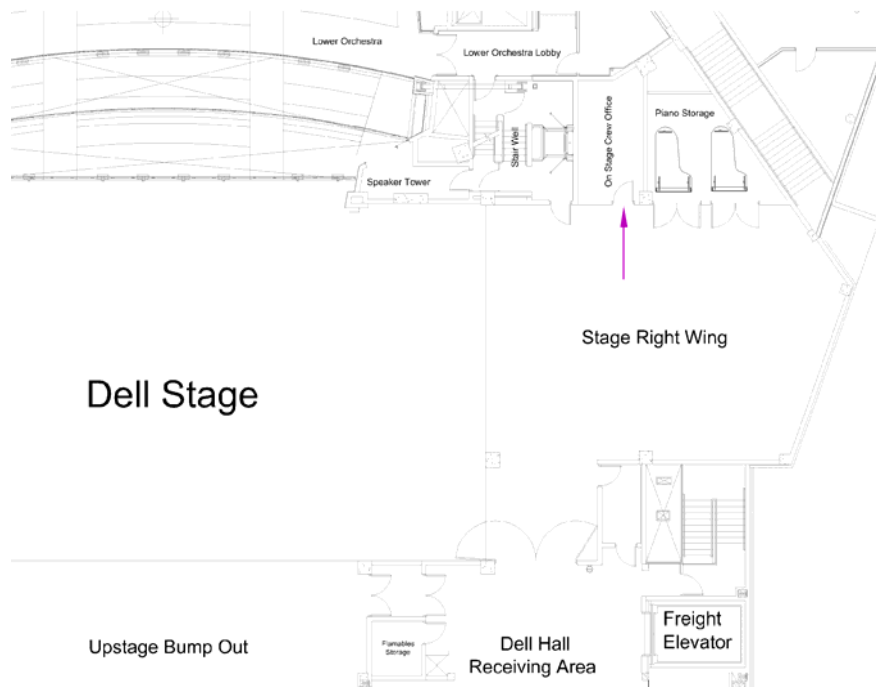

five chairs.

- Clear-Com Squawk Box on wall.

### Dell Hall - Blank Hang Schedule

Line set	From Plaster	Piece	Show	Dist from C/L		Trim	Weight/Bricks	Notes
				SL	SR			
FC	0'-5"	Fire Curtain	House				MAX	WINCH
HC	1'-4"	House Curtain	House				MAX	WINCH
1	2'-00"	Hard Border	House				MAX	60'X20"
2	2'-5"	Hard Legs	House				MAX	10'X36' each
	2'-11"	<b>Big Movie Screen</b>	<b>32'X26'</b>	Movie Screen Dead Hung from Grid				
3	3'-6"							
4	4'-00"							
5	4'-8"							
6	5'-4"							
7-S1	6'-3"	#1 Shell Ceiling	House				MAX	
8	6'-8"	lock	Lock				Lock	Lock
9	7'-4"							
10	8'-00"							
11	8'-8"							
12	9'-4"							
13	10'-00"							
14	10'-8"							
15	11'-4"							
16	12'-00"							
17	12'-8"							
18	13'-4"							
19	14'-00"							
20	14'-6"							
21-S2	15'-5"	#2 Shell Ceiling	House				MAX	
22	16'-00"	lock	Lock				Lock	Lock
23	16'-8"							
24	17'-4"							
25	18'-00"							
26	18'-8"							
27	19'-4"							
28	20'-00"							
29	20'-8"							
30	21'-4"							
31	22'-00"							
32	22'-7 1/2"							
33	23'-3 1/2"							
34	23'-11 1/2"							
35-S3	24'-9"	#3 Shell Ceiling	House				MAX	
36	25'-4"	lock	Lock				Lock	Lock
1 pair of tabs= 8 bricks		tab=4 bricks	10'x40' each	Green indicates linesets that clear between shell ceilings				
1 pair of legs= 10 bricks		leg=5 bricks	16'x40' each	that are deployed				
border=8 bricks w/out		border=13 bricks w/ pipe						

pipe	70'x10'	
white bounce=14 bricks	Black Panel=28 70'x38'	28'X16' small movie screen is store in bump out
RP Screen= 20 bricks	Single Trav Panel=12 bricks 36'x40'	
Black Scrim= 8 bricks	Traveler Panels w/track=39 bricks	

Line set	From Plaster	Piece	Show notes	Dist from C/L		Trim	Weight	Notes
				SL	SR			
37	26'-00"							
38	26'-8"							
39	27'-4"							
40	27'-11 1/2"							
41	28'-7 1/2"							
42	29'-3 1/2"							
43	29'-11 1/2"							
44	30'-7 1/2"							
45	31'-4"							
46	31'-11 1/2"							
47	32'-7 1/2"							
48	33'-4"							
<b>49-S4</b>	<b>34'-2"</b>	<b>#4 Shell Ceiling</b>	<b>House</b>				<b>MAX</b>	
50	34'-6 1/2"	<b>Lock</b>	<b>Lock</b>				<b>Lock</b>	<b>Lock</b>
51	35'-1"	<b>Lock</b>	<b>Lock</b>				<b>Lock</b>	<b>Lock</b>
52	35'-11"							
53	36'-7 1/2"							
54	37'-3 1/2"							
55	37'-11 1/2"							
56	38'-7 1/2"							
57	39'-4"							
58	40'-00"							
59	40'-8"							
60	41'-3 1/2"							
61	42'-00"							
62	42'-8"							
<b>63-S5</b>	<b>43'-4"</b>	<b>#5 Shell Ceiling</b>	<b>House</b>				<b>MAX</b>	
64	44'-00"	<b>Lock</b>	<b>House</b>				<b>Lock</b>	<b>Lock</b>
65	44'-7 1/2"							
66	45'-4"							
67	46'-00"							
68	46'-8"							
69	47'-4"							
70	47'-11 1/2"							
71	48'-7 1/2"							
72	49'-4"							
73	50'-00"							
<b>74</b>	<b>51'-00"</b>	<b>Traveler Panels w/ Track</b>	<b>HouseStorage</b>				<b>39</b>	<b>36'X40' each</b>
1 pair of tabs= 8 bricks	tab=4 bricks 10'x40' each							Green indicates linesets that clear between shell ceilings

1 pair of legs= 10 bricks	leg=5 bricks 16'x40' each	that are deployed
border=8 bricks w/out pipe	border=13 bricks w/ pipe 70'x10'	
white bounce=14 bricks	Black Panel=28 70'x38'	28'X16' small movie screen is store in bump out
RP Screen= 20 bricks	Single Trav Panel=12 bricks 36'x40'	
Black Scrim= 8 bricks	Traveler Panels w/track=39 bricks	

## Long Center Photos



The Long Center's Grand Staircase to main entrance of Dell Hall on the right  
Rollins Lobby Doors are to the left of the stairs at ground level



Aerial photo of The Long Center & Palmer Events Center Parking Garage